

OPERATOR'S MANUAL

SUPPLEMENT

Model No. 435B
436C

WARNING:

Read Engine
Owner's Manual,
Vehicle Operator's
Manual, and
Supplement
Carefully Before
Operating Vehicle.

Parts List



4404 Engle Ridge Drive, Fort Wayne, IN 46804
ph (260) 432-1596 fx (260) 432-7870

**THIS VEHICLE IS FOR
OFF-ROAD USE ONLY**

BEFORE OPERATING THIS VEHICLE, THE OWNER AND/OR OPERATOR MUST UNDERSTAND THE VEHICLE WAS NOT DESIGNED OR MANUFACTURED TO MEET SPECIFICATIONS FOR USE ON STREETS, HIGHWAYS, OR THOROUGHFARES AND HAVE READ AND HAVE AN UNDERSTANDING OF ALL THE INSTRUCTIONS FOR SAFE ASSEMBLY AND OPERATION AS WELL AS THE INSTRUCTIONS GOVERNING THE ENGINE AND OTHER PORTIONS OF THE VEHICLE.

PARTS LIST MODELS 435B & 436C

| REF | PART # | DESCRIPTION |
|------------|----------|--------------------------------------|
| | 13421-2 | FRAME - BLACK |
| | 13421-7 | FRAME - LIME GREEN |
| | 13421-13 | FRAME - ORANGE |
| | 13421-37 | FRAME - RED WAGON |
| | 13421-39 | FRAME - TRAFFIC YELLOW |
| ASM | 10889 | TIE ROD ASSY LONG (INCL 2, 4 - 7) |
| ASM | 5020 | TIE ROD ASSY SHORT (INCL 3 - 7) |
| 2 | 10888 | TIE ROD - 19.00 INCH |
| 3 | 5004 | TIE ROD - 7.25 INCH |
| 4 | 1415 | TIE ROD END - LEFT |
| 5 | 1414 | TIE ROD END - RIGHT |
| 6 | 9024 | NUT 3/8-24 JAM - LEFT |
| 7 | 9092 | NUT 3/8-24 JAM - RIGHT |
| 8 | 9674-16 | SPACER 3/8ID X 3/8L ZINC |
| 9 | 9146 | BOLT 3/8-16 X 1.50 HHCS G5 ZINC |
| 10 | 9158 | BOLT 3/8-16 X 2.25 HHCS G5 ZINC |
| 11 | 9006 | BOLT 1/4-20 X .50 HH WHIZ FLANGE |
| 12 | 10548-22 | LEFT SPINDLE BLACK WITH ZERK |
| NI | 10549-22 | RIGHT SPINDLE BLACK WITH ZERK |
| 13 | 9709 | COMPRESSION SPRING |
| 14 | 5682 | BOLT 1/2-13 X 5.50 HHCS G5 ZINC |
| 15 | 1012 | NUT 1/2-13 TOPLOCK HEX ZINC |
| 16 | 13354 | NUT 5/8-11 CENTERLOCK HEX ZINC |
| 17 | 1104 | SPLIT SPACER .8120D X .625ID X 1.00L |
| 18 | 12490 | WHEEL ASSY 6INCH (INCL 21 & 22) |
| NI | 4915C | REPLACEMENT TIRE FOR #18 |
| NI | 3802 | REPLACEMENT TUBE FOR #18 |
| 19 | 13355 | NUT 3/4-10 CENTERLOCK ZINC |
| 20 | 1168 | WASHER 3/4 STEEL ZINC |
| 21 | 5090 | BEARING 5/8 ID X 1-3/8 OD |
| 22 | 5950 | SPANNER 5/8 ID X 2-1/8 |
| 23 | 12778 | WHEEL ASSY 6INCH DRIVE |
| 24 | 13407 | SPROCKET W/DRUM 420 X 27T |
| 25 | 11808 | VINYL CAP 1.50 X 1.50 |
| 26 | 6788 | SPANNER 5/8ID X 14G X 5.875 |
| 28 | 1136 | NUT 5/8-18 CENTERLOCK HEX JAM ZINC |
| 31 | 9085 | NUT 3/8-16 TOPLOCK HEX ZINC |
| 32 | 1119 | SPACER .625ID X 1.0620D X .125THK |
| 33 | 13473 | BOLT 3/8-16 X 4.50 HH G5 ZINC |
| 34 | 6309-16 | THRATTLE PEDAL |
| 35 | 9503 | PEDAL SPRING - RIGHT WOUND |
| 37 | 8251 | THRATTLE CABLE - 74.50 INCH |
| 38 | 12348 | RETURN SPRING |

| REF | PART # | DESCRIPTION |
|-----------|---------|-------------------------------------|
| 39 | 12347 | SWIVEL SCREW |
| 40 | 6293-16 | BRAKE PEDAL |
| 41 | 9502 | PEDAL SPRING - LEFT WOUND |
| 42 | 1848 | BOLT 1/4-20 X 1.25 HHCS G5 ZINC |
| 43 | 2072 | JACKSHAFT 5/8 X 10.375 |
| 44 | 1389 | BUSHING .25ID X .031G X .313 |
| 45 | 1447 | BOLT 5/16-18 X 3/8 X 1-1/8 SHOULDER |
| 46 | 9091 | WASHER FLAT 3/8 SAE ZINC |
| 47 | 13426 | BRAKE CABLE |
| 48 | 12093 | BUSHING 5/8ID X 1/2 L ZINC |
| 49 | 1036 | BRAKE BAND |
| 50 | 9118 | CLEVIS PIN |
| 51 | 9116 | COTTER PIN |
| 52 | 6038 | STEERING WHEEL |
| 53 | 9799 | STOP SWITCH WIRE ASSY |
| NI | 9796 | BOLT NBR12-24 X .50 SELF TAPPING |
| NI | 1463 | INSULATING BUSHING - BLACK |
| NI | 5287 | BOLT NBR 10-16 X .375 SELF TAPPING |
| NI | 5288 | WIRE CLAMP |
| NI | 12273 | WIRE HARNESS |
| 54 | 9080 | BOLT 1/4-20 X 2.75 HHCS G2 ZINC |
| 55 | 9160 | BOLT 1/4-20 X .875 NYLOCK HHCS G5 Z |
| 56 | 1030 | KEY 3/16 SQ X .75 |
| 57 | 6320 | HEADREST - SINGLE |
| 58 | 12734 | SEAT - BACK/BOTTOM |
| 59 | 1263 | NUT 5/16-18 HEX WHIZ FLANGE ZINC |
| 61 | 13443 | TOP GUARD |
| 62 | 13310-2 | PEDAL LATCH - BLACK |
| 63 | 1846 | BOLT 1/4-20 X .750 HHCS G5 ZINC |
| 64 | 9057 | NUT 1/4-20 TOPLOCK ZINC |
| 65 | 1854 | WASHER NBR 14 FLAT ZINC |
| 66 | 4372 | HANDHOLD |
| 69 | 2388 | NUT 3/8-24 HEX ZINC |
| 70 | 5732 | WASHER 1/4 EXTERNAL LOCK ZINC |
| 71 | 13442 | BOTTOM GUARD |
| 72 | 9724 | CHAIN 420 X 42P AE (INCL #110) |
| 73 | 13406 | SPROCKET 420 X 23T 5/8BORE |
| 74 | 13418 | JACKSHAFT 3/4 X 21.375 |
| 75 | 1938 | SPACER .75ID X 11G X .375 ZINC |
| 76 | 3403 | KEY 3/16 SQ X 2.00 |
| 77 | 8778 | HARNESS - LAP/SHOULDER |
| 78 | 1031 | KEY 3/16 SQ X .50 |

| REF | PART # | DESCRIPTION |
|---|---------|--|
| 79 | 9188 | BOLT 1/2-13 X 1.50 HHCS G5 ZINC |
| 80 | 9022 | WASHER 1/2 STD FLAT ZINC |
| 81 | 2386 | BOLT 3/8-16 X 3.50 HHCS G5 ZINC |
| 82 | 1398 | WASHER 21/64 ID X 1-1/4 X 1/8 |
| 83 | 13522 | IMPELLER |
| 84 | 1189 | NUT 5/16-18 TOPLOCK HEX ZINC |
| 85 | 9189 | BOLT 1/4-20 X .875 HH WHIZ FLANGE |
| 86 | 1876 | BOLT 1/4-20 X .625 HH WHIZ FLANGE |
| 87 | 9968-2 | SEAT FRAME - BLACK |
| 88 | 6734 | SEAT SLIDE - PAIR |
| 89 | 5447 | SAFETY FLAG - 6 FT |
| 90 | 12246 | ENGINE - NON COIL |
| | 12250 | ENGINE - WITH COIL (MODELS W/ RUN LIGHTS ONLY) |
| 91 | 8720 | SPROCKET 420P X 9T |
| 92 | 12884 | CLUTCH 41-10T |
| 93 | 11361 | BOLT - FLAG MOUNTING |
| 94 | 9060 | WASHER 5/16 TYPE A SAE ZINC |
| 95 | 1138 | BOLT 5/8-11 X 7.00 HHCS G5 ZINC |
| 96 | 1124 | WASHER 5/16 SPLIT LOCK ZINC |
| 97 | 8139 | BOLT 5/16-24 X 1.00 HHCS G5 ZINC |
| 98 | 13427 | SPANNER 3/4 ID X 13.942 |
| 100 | 12783 | BEARING 3/4 ID X 1-3/4 OD SNAP RING |
| 101 | 9101 | BOLT 5/16-24 X .50 NYLOCK HHCS G5 |
| 102 | 9186 | BOLT 5/16-18 X 1.50 HHCS G5 ZINC |
| 103 | 9030 | WASHER 5/16 INTERNAL LOCK ZINC |
| 104 | 13409-2 | TAV CHASSIS - BLACK |
| 105 | 8227 | NUT 1/4-20 CLIP |
| 106 | 13452-2 | BACKING PLATE - BLACK |
| 107 | 13568-2 | OVERHEAD BAR - BLACK |
| 108 | 12731-2 | HEADREST WDMT - BLACK |
| 109 | 13071-2 | CENTER/REAR BAR - BLACK |
| 110 | 2037 | MASTER LINK 420 CHAIN |
| 111 | 13559 | CHAIN 420 X 40P AE (INCL #110) |
| ADDITIONAL PARTS FOR MODEL 436C ONLY | | |
| NI | 12794 | RUN LIGHT KIT |
| NI | 13097 | REPLACEMENT RUN LIGHTS - PAIR |
| NI | 9399 | 10 AMP FUSE (FOR RUN LIGHTS) |
| NI | 12795-2 | RUN LIGHT MOUNT BRACKET - BLACK |

ASM = ASSEMBLY

NI = NOT ILLUSTRATED

****** = NOT SOLD SEPERATELY

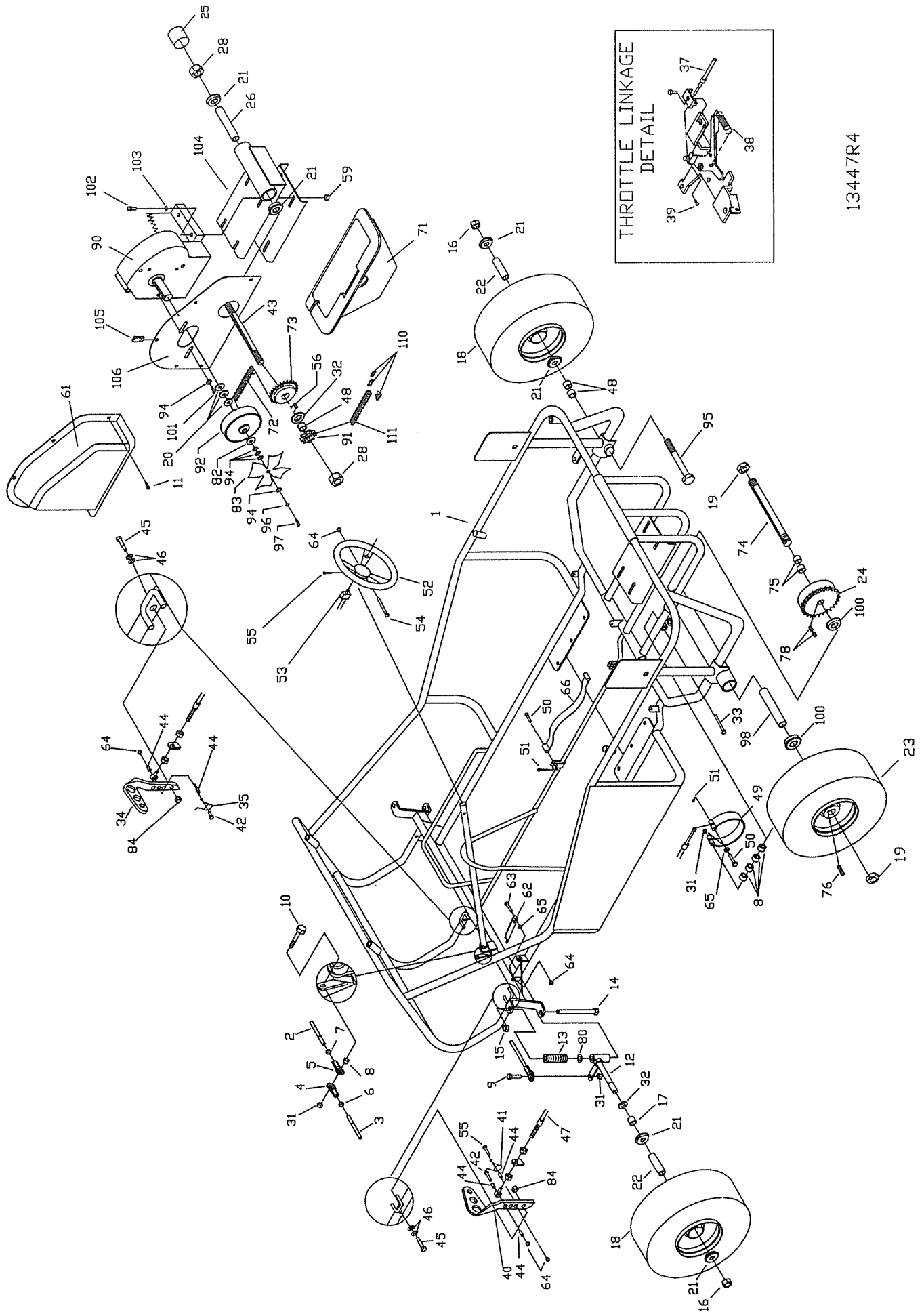

13447R4

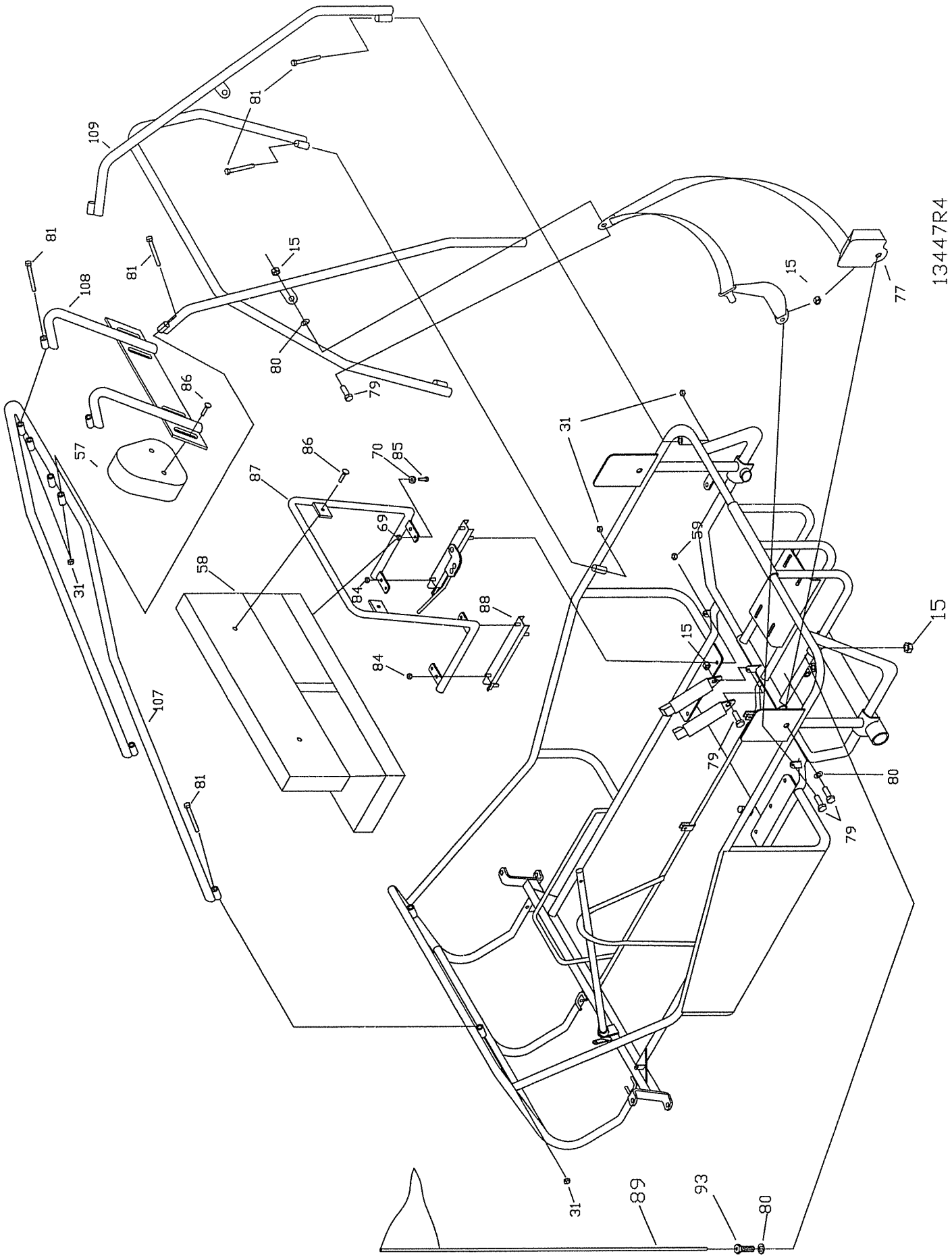

13447R4